

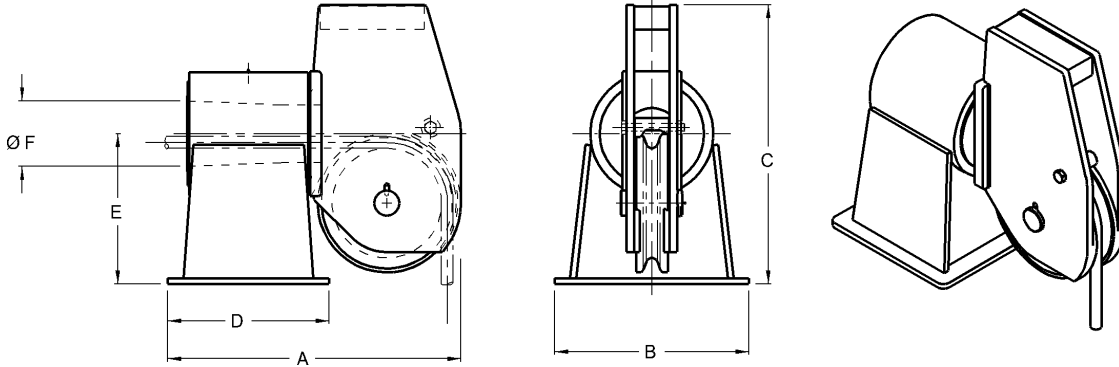

Deck Mounted Balanced Head Fairleads



Model Number	Units of Measure	Maximum Wire Size	Wire Breaking Strength	Sheave Tread Diameter	A	B	C	D	E	F	Weight
MD-610	Inches	3/4	58,800 lbs.	8- 1/4	23-11/16	16	20- 1/8	14- 3/4	11	4- 1/2	270 lbs.
	MM	19	262 kN	210	602	406	511	375	279	114	122 Kg
MD-612	Inches	1	103,400 lbs.	9- 3/4	28- 3/16	19- 1/4	24- 5/8	17- 3/4	13- 1/2	5- 5/8	495 lbs.
	MM	25	460 kN	248	716	489	625	451	343	143	225 Kg
MD-614	Inches	1- 1/4	159,800 lbs.	11- 1/4	30- 9/16	20	28-1/8	18-1/2	15-1/2	6-5/16	670 lbs.
	MM	32	711 kN	286	776	508	714	470	394	160	304 Kg
MD-618	Inches	1- 1/2	228,000 lbs.	14- 1/4	38- 1/8	25- 1/4	36- 1/4	21	19- 1/2	8- 1/2	1450 lbs.
	MM	38	1014 kN	362	968	641	921	533	495	216	658 Kg
MC-622	Inches	1- 3/4	266,000 lbs.	18- 1/2	45- 1/8	28- 1/2	45- 1/2	22	23- 1/2	9- 1/2	2100 lbs.
	MM	44	1183kN	470	1146	724	1156	559	597	241	953 Kg

Standard Features

- Designed for breaking strength of wire with 90° wrap on sheave and +/- 90° rotation of swivelhead
- Sealed grease lubricated Timken tapered roller bearings
- Hardened rope grooves for longer life
- Weld down base
- Removable guide roller
- Smith Berger Quality

Optional Features

- Tail Sheaves / Tail Rollers
- Bolt down base
- Load monitoring system
- Special sheaves for high performance synthetic ropes
- Paint to your specification
- Third party certification

*We will custom engineer any of our products to suit **YOUR** requirements!*

7915 10th Ave. S., Seattle, WA 98108 USA - Tel: 206-764-4650 - Fax: 206-764-4653 - Website: www.SmithBerger.com



Deck Mounted Balanced Head Fairleads

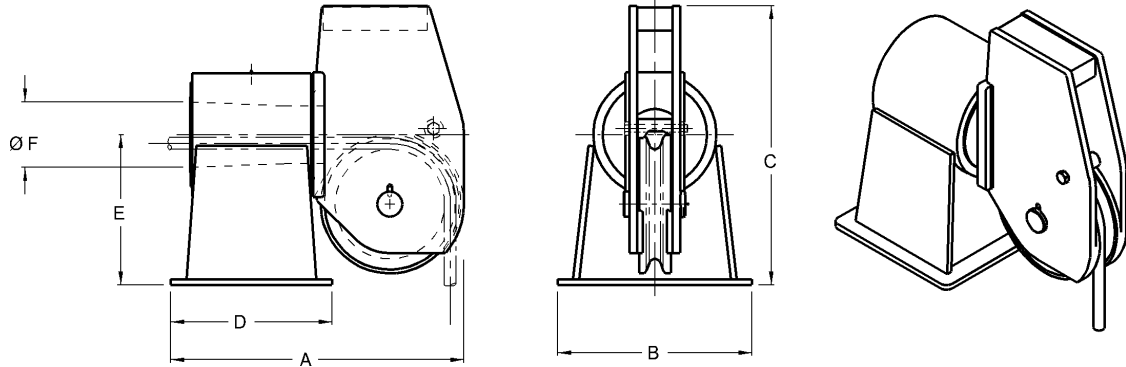

Model Number	Units of Measure	Maximum Wire Size	Wire Breaking Strength	Sheave Tread Diameter	A	B	C	D	E	F	Weight
MC-624	Inches	2	344,000 lbs.	20	50- 1/8	30	44-13/16	27	25- 1/2	12	2650 lbs.
	MM	51	1530 kN	508	1273	762	1138	686	648	305	1202 Kg
MD-630	Inches	2- 1/4	494,000 lbs.	24- 7/8	56- 7/8	40- 1/4	60- 3/4	27- 1/2	31- 1/2	13	4800 lbs.
	MM	57	2198 kN	632	1445	1022	1543	699	800	330	2177 Kg
MC-636	Inches	2- 1/2	524,000 lbs.	30	63	40	70- 1/4	27- 1/2	36- 1/4	14- 1/2	6000 lbs.
	MM	64	2331 kN	762	1600	1016	1784	699	921	368	2722 Kg
MD-652	Inches	3	818,000 lbs.	44	103- 1/2	52- 3/8	104	44	34- 1/2	26- 1/2	16,500 lbs.
	MM	76	3639 kN	1118	2629	1330	2642	1118	876	673	7484 Kg
MD-665	Inches	3	818,000 lbs.	55- 1/2	115- 5/8	52- 3/8	117- 1/2	44	34- 1/2	26- 1/2	18,800 lbs.
	MM	76	3639 kN	1410	2937	1330	2985	1118	876	673	8528 Kg

Standard Features

- Designed for breaking strength of wire with 90° wrap on sheave and +/- 90° rotation of swivelhead
- Sealed grease lubricated Timken tapered roller bearings
- Hardened rope grooves for longer life
- Weld down base
- Removable guide roller
- Smith Berger Quality

Optional Features

- Tail Sheaves / Tail Rollers
- Load monitoring system
- Paint to your specification
- Bolt down base
- Special sheaves for high performance synthetic ropes
- Third party certification

*We will custom engineer any of our products to suit **YOUR** requirements!*