

HOOK TYPE	LINE SIZE	NOMINAL LOAD PER HOOK			TOTAL LOAD PER UNIT			HOOK WEIGHT		WEIGHT HOOK(S) W/BASE	
CSRH-25	3	25 TONS			25 TONS			125 LBS.		263 LBS.	
		A 4	B 17½	C 22¼	D 15	E 14¼	F 2	G 1¼	H 1	J 10½	K 37¼
CSRH-50	3	50 TONS			50 TONS			166 LBS.		304 LBS.	
		A 4½	B 17½	C 22¼	D 15	E 14¼	F 2	G 1¼	H 1	J 10½	K 37¼

NOTE: ALL DIMENSIONS IN INCHES

CAPTIVE RELEASE HOOK

(LIGHT TOWING HOOK)

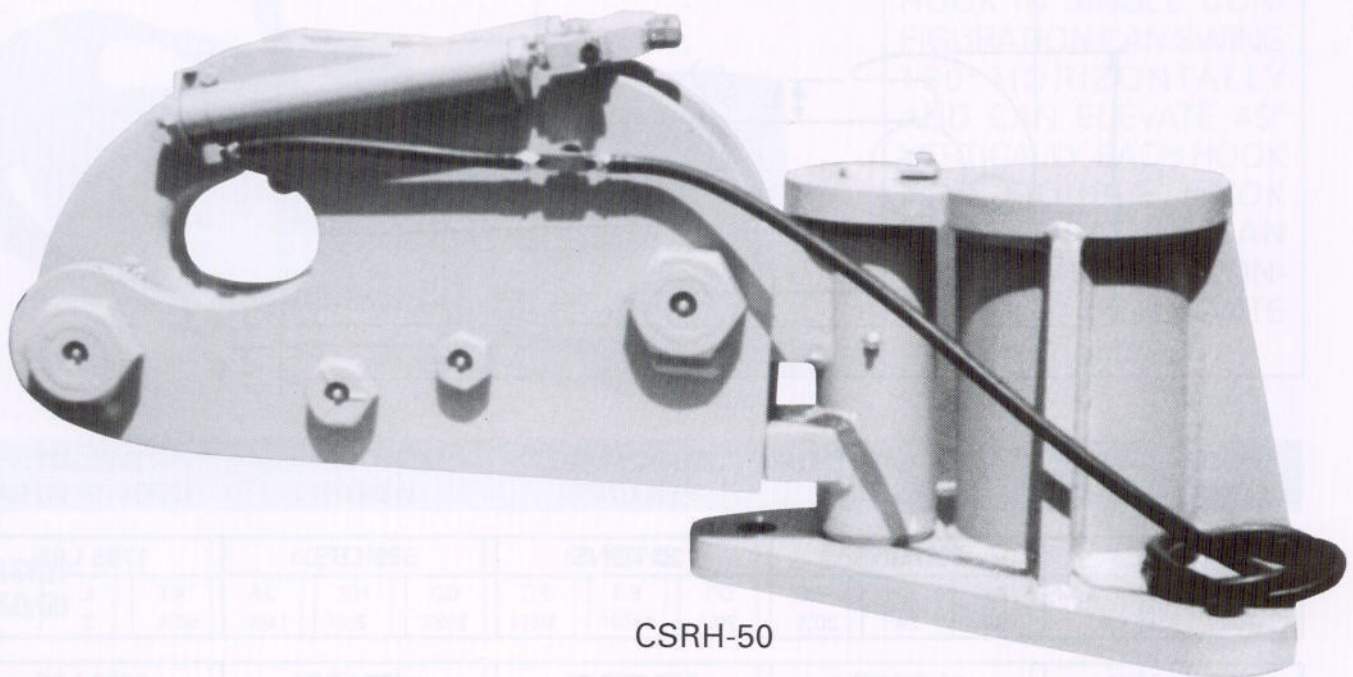

CSRH-50

NOTE

HOOK CAN SWING 180° HORIZONTALLY
AND CAN ELEVATE 45° VERTICALLY

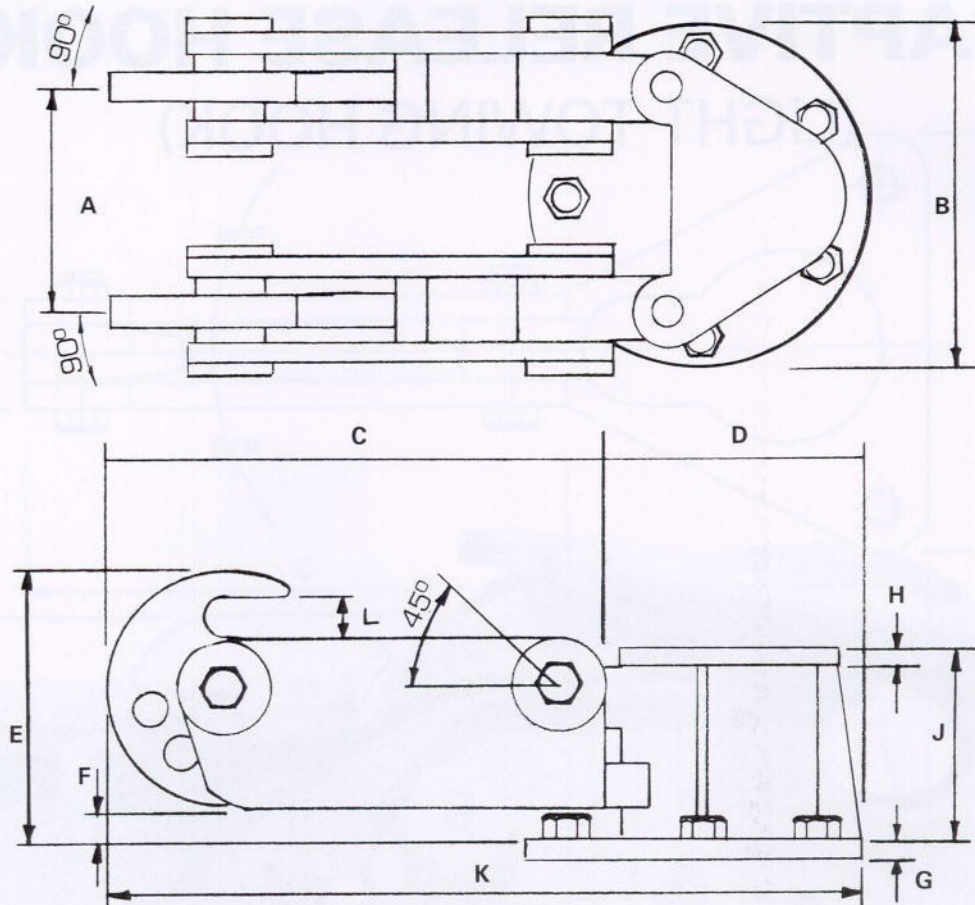

HOOK TYPE	LINE SIZE	NOMINAL LOAD PER HOOK			TOTAL LOAD PER UNIT			HOOK WEIGHT			WEIGHT HOOK(S) W/BASE		
RDRH-50/60	3	60 TONS			120 TONS			579 LBS.			1795 LBS.		
		A 16	B 24	C 30½	D 20	E 16½	F 1½	G 2¼	H 2	J 14½	K 50½	L 3	
RDRH-80	3½	80 TONS			160 TONS			1000 LBS.			2950 LBS.		
		A 18	B 28½	C 38¼	D 23¾	E 20½	F 2	G 2½	H 2¼	J 16	K 62	L 3½	
RDRH-100	3½	100 TONS			200 TONS			1450 LBS.			3850 LBS.		
		A 20	B 31½	C 42½	D 26½	E 23	F 2	G 2½	H 2¼	J 17½	K 69	L 4	
RDRH-150	5	150 TONS			300 TONS			2250 LBS.			5700 LBS.		
		A 24	B 34	C 52½	D 29	E 28	F 2	G 3	H 2½	J 19½	K 81½	L 5	
RDRH-200	5	200 TONS			400 TONS			2350 LBS.			5900 LBS.		
		A 24	B 34	C 52½	D 29	E 28	F 2	G 3	H 2½	J 19½	K 81½	L 5	

NOTE: ALL DIMENSIONS IN INCHES

ROTARY RELEASE HOOKS

All of our standard air- and hydraulic-release hooks provide good dampening against the sudden shock of line release under load. These rotary-release models, though, go a step further. By spinning freely, they remove the strain from the hook itself, rather than using a bumper pad to absorb recoil. This provides for smoother release and allows the hooks to handle higher loads.

In addition, the smoother release prolongs the life of both the hook itself and the mooring lines it handles. Of course, like our other models, rotary release hooks are made of heat-treated alloy steel, are hot-sprayed with zinc before finishing, and include the same safety features and ease of maintenance.

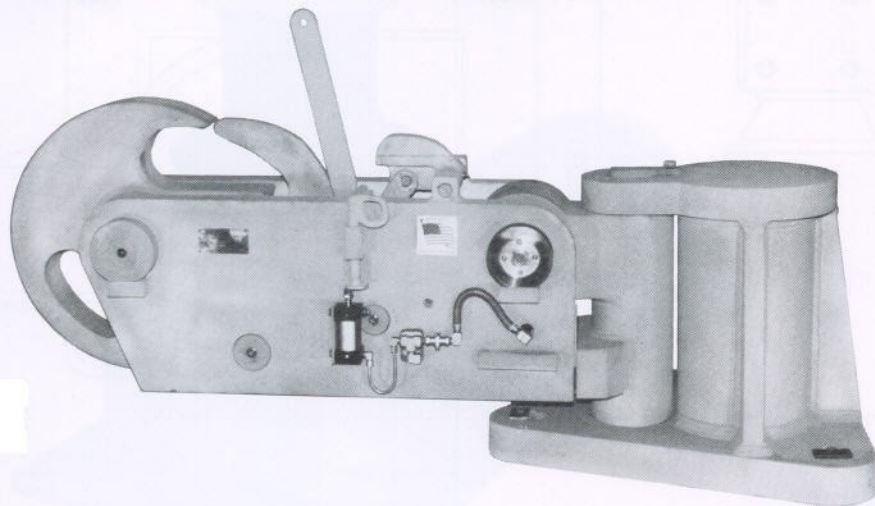

NOTE

HOOK IN SINGLE CONFIGURATION CAN SWING 180° HORIZONTALLY AND CAN ELEVATE 45° VERTICALLY. EACH HOOK IN A DOUBLE HOOK CONFIGURATION CAN SWING 140° HORIZONTALLY AND CAN ELEVATE 45° VERTICALLY

HOOK TYPE	LINE SIZE	NOMINAL LOAD PER HOOK			TOTAL LOAD PER UNIT			HOOK WEIGHT			WEIGHT HOOK(S) W/BASE	
RSRH-50/60	3	60 TONS			60 TONS			579 LBS.			889 LBS.	
		A 7½	B 19½	C 30½	D 17½	E 16½	F 1½	G 2	H 1¾	J 13½	K	
RSRH-80	3½	80 TONS			80 TONS			1000 LBS.			1800 LBS.	
		A 9½	B 24	C 38¾	D 23	E 20½	F 2	G 2½	H 2¼	J 17¼	K 61¼	
RSRH-100	3½	100 TONS			100 TONS			1450 LBS.			2200 LBS.	
		A 9	B 24	C 42½	D 23	E 23	F 2	G 2½	H 2¼	J 17¼	K 69	
RSRH-150	5	150 TONS			300 TONS			2250 LBS.			3073 LBS.	
		A 10½	B 25	C 52½	D 23	E 28	F 2	G 2½	H 2¼	J 17¼	K 75½	
RSRH-200	5	200 TONS			200 TONS			2350 LBS.			3200 LBS.	
		A 10½	B 25	C 52½	D 23	E 28	F 2	G 2½	H 2½	J 17¼	K 75½	

NOTE: ALL DIMENSIONS IN INCHES

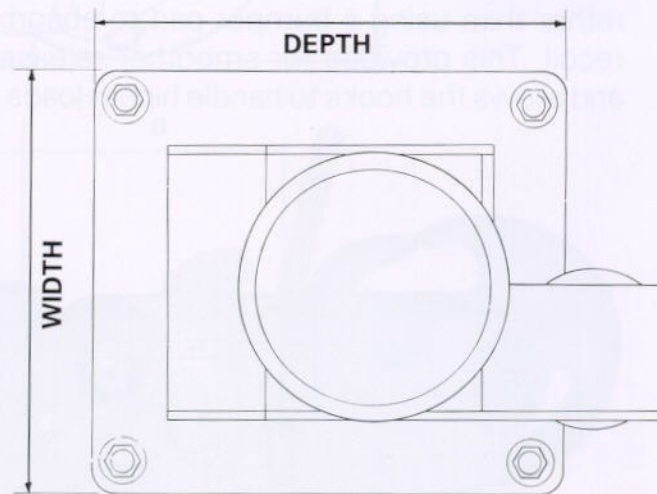
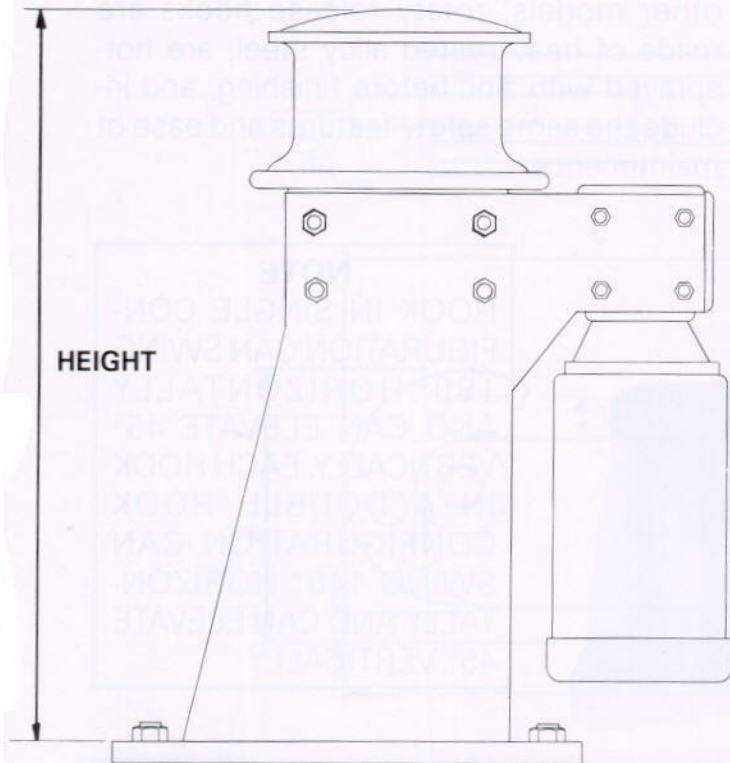

MODEL	HP	LINE SPEED (fpm)	LINE PULL (lbs.)	WEIGHT (approx.)	HEIGHT	WIDTH	DEPTH
FSC-5	5	75	1,700	900	44	22½	30
FSC-7.5	7.5	75	2,600	950	44	22½	32
FSC-10	10	75	3,000	1,050	44	22½	32
FSC-15	15	75	5,000	2,300	44	28	38

NOTE: ALL DIMENSIONS IN INCHES; OTHER LINE SPEED AND LINE PULL COMBINATIONS ARE AVAILABLE

CAPSTANS

We manufacture a variety of capstans, both freestanding and as an integral part of another unit. Our standard models will meet the needs of almost any application, but custom fabrication is also available

to accommodate specific requirements. All models are available with either one- or two-way drive, and with a variety of capstan head sizes and styles to match your specifications.

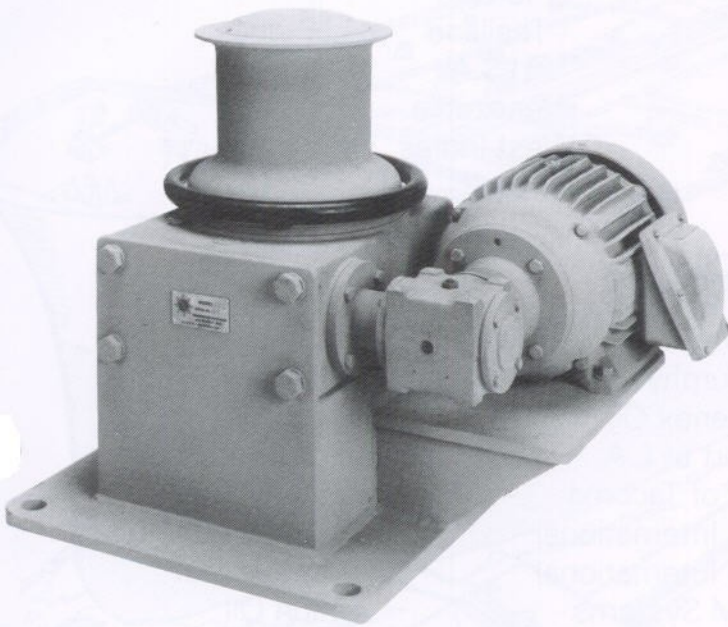

LSC-10
"LOWBOY" MODEL

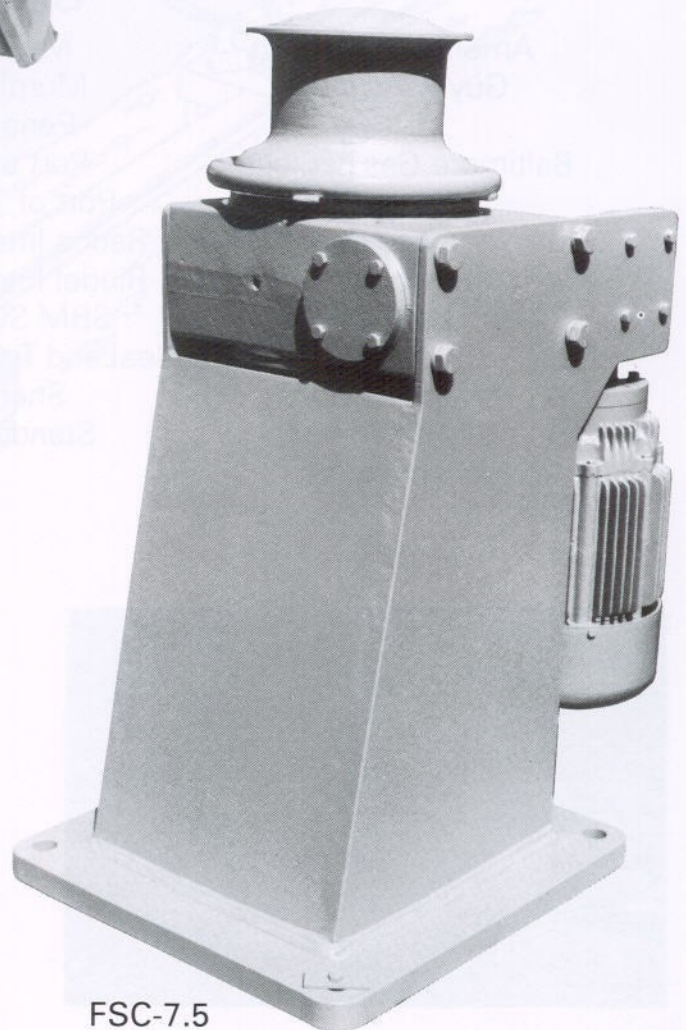

FSC-7.5